

AGM Weekend – Garden 2

The second garden we visited on our AGM weekend was also in Howth. It was a garden where it was obvious that the gardeners, for both were very keen gardeners, were very interested in plants and there was a wide and varied selection to be seen. Indeed, we were given plant lists to make our visit all the more interesting.

The garden was very well divided so that one had the experience of wandering from section to section and enjoying a different setting as one went around.

Here is a selection of photographs from the garden which I hope will give you an idea of what we enjoyed, the various parts of the garden and some of the plants on view.



This was the view on entering the garden, a number of aralias to give height and an Echimium pininana in flower. The upright nature of the plants seemed to compliment the uprights of the house veranda perfectly. The underplanting in this area was united by the acid green of the euphorbias.



Enjoying the planting at the front of the house. There was much to admire and, as you can see, the weather was perfect for our visit.



Many people commented on the colour combination of the tulips and the euphorbia.





This was the main border in the garden and was planted with a mixture of herbaceous perennials with some shrubs to give substance.



There was much to admire there.



The glasshouse was used mainly for growing vegetable and raising plants for the garden.



I think gardeners rarely use the seats they place in the garden but they are appreciated by visitors.



And the view from the seat was very pleasant.

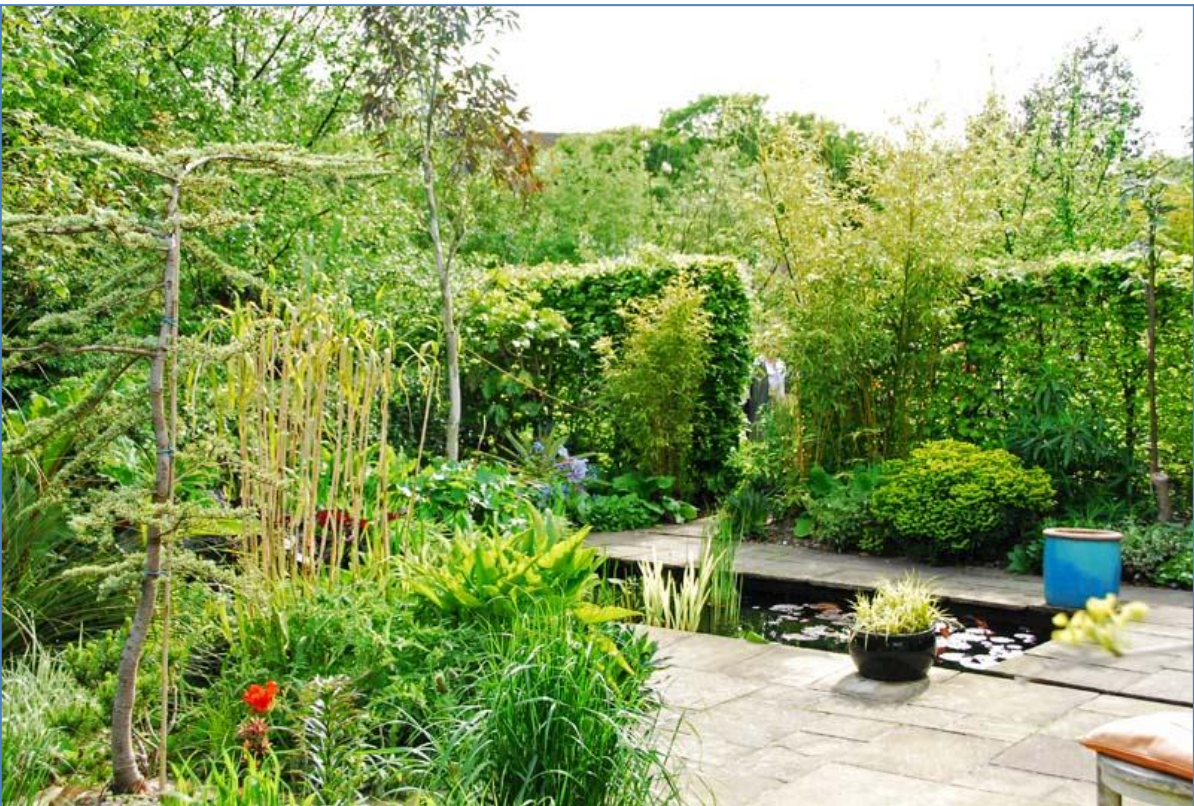

The stroll leads down a flight of steps to this pool area, a very peaceful part of the garden.



All eyes were drawn to the beautiful meconopsis in the pond area.



Despite the small size of the garden there was still room for a small copse.



The contour of the ground created a small glen in this area and it was perfectly planted with a range of rhododendrons.



A good way to mark an entrance!



In Howth, rock is never far from the surface and provides wonderful opportunities for interesting planting.



And, finally, an attractively colour abutilon to finish our garden walk.